

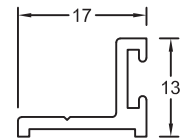

Section No.F9758  
Wide Standout Door Frame  
1.200kg/m, per 370

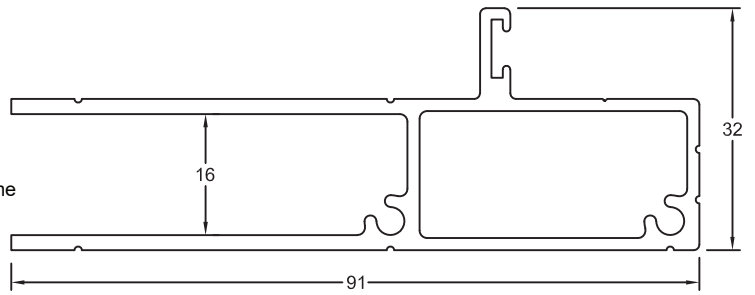

Section No.6136  
Door Stop  
0.150kg/m, per 72

Section No.J007  
Standout Door Frame  
1.077kg/m, per 321

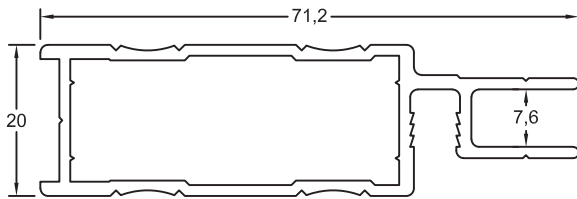
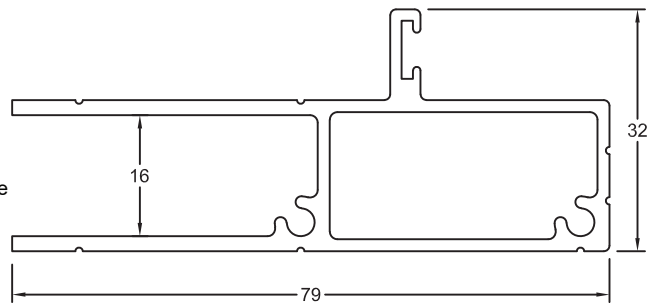

Section No.Z785  
Door Frame  
0.771kg/m, per 240

Section No.6868K  
Corner Stake  
For Z785

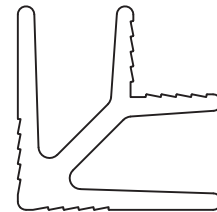

Section No.30971  
32mm Sliding Door  
Top Track  
0.483kg/m, per 218

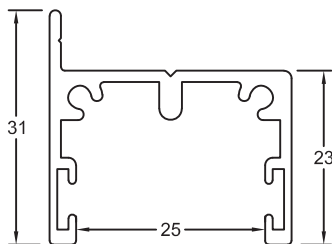

Section No.30972  
47mm Sliding Door  
Channel  
0.936kg/m, per 296

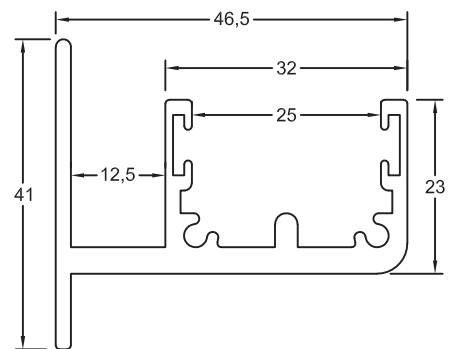

Section No.33629  
32mm Sliding Door  
Bottom Track  
0.483kg/m, per 218

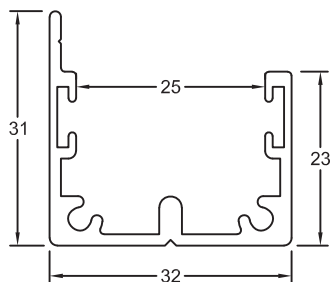

Section No.DR234  
SL Spring Loaded Security  
Door Carriage  
Material Zinc Seal  
Standard Roller: RD 35  
Max Load: 25kg

