

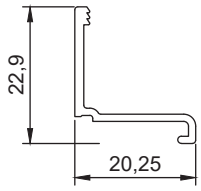

Stocked Sections (PTN) Internal Glazing Sections

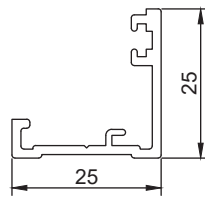

Section No. E771
0.159 kg/m, per 89.6



Section No. E772
0.284 kg/m, per 140.1

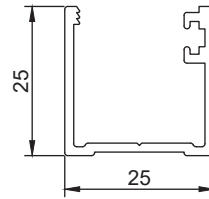

Section No. E770
0.347 kg/m, per 167.7

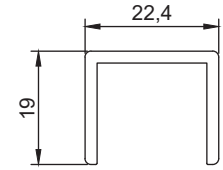

Section No. 30504
0.303 kg/m, per 114.9

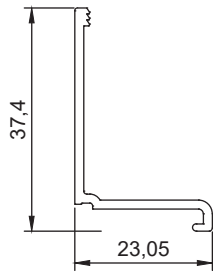

Section No. G674
0.247 kg/m, per 124.1

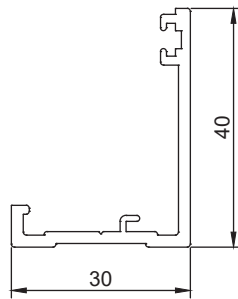

Section No. G675
0.448 kg/m, per 178.2

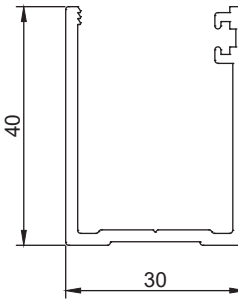

Section No. G673
0.613 kg/m, per 234.7

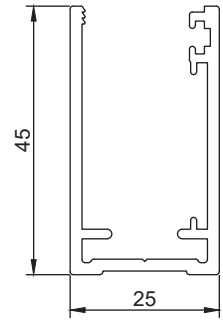

Section No. 31427
0.693 kg/m, per 270.6

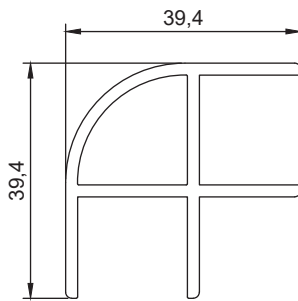

Section No. 30505
0.764 kg/m, per 280.6

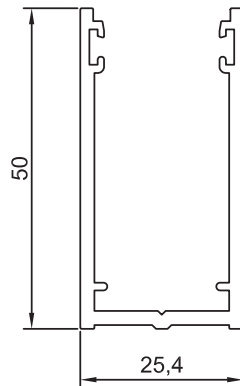

Section No. 33604
0.742 kg/m, per 276

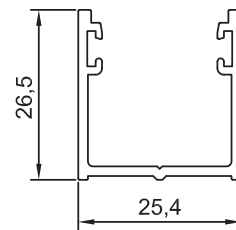

Section No. 33602
0.353 kg/m, per 158.4

Section No. Z661
0.184 kg/m, per 114.9

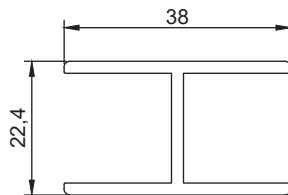

Section No. 30503
0.509 kg/m, per 190.7

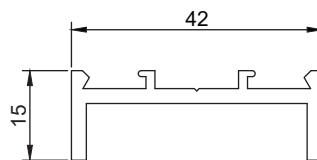

Section No. 5620
0.484 kg/m, per 157.0

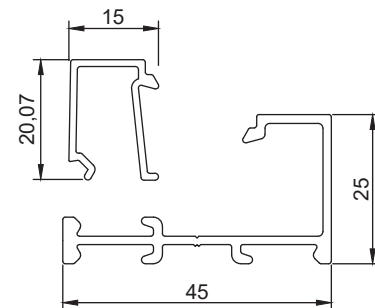

Section No. Z662
0.442 kg/m, per 207.7

*stock in mill & powdercoated titania. Subject to stock availability at time of order.